

Lites

PROFILE LED WHITE

Owner's and Service Manual

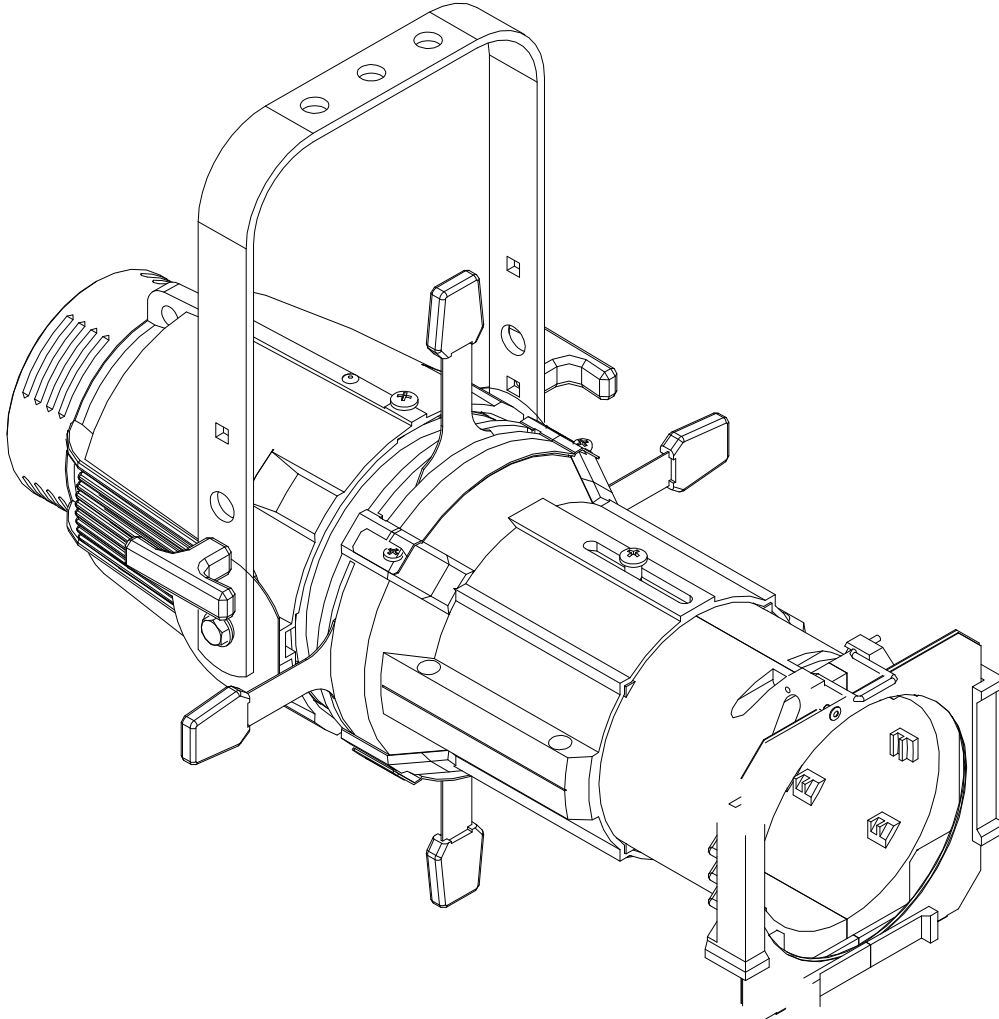

Read this manual carefully, and follow all instructions contained herein. File this manual for future reference.

It is essential to read and follow guidelines and other information contained in this manual to ensure proper installation, service and full operation of the HPLED. All operations must be performed only by qualified personnel.

NON-COMPLIANCE WITH GUIDELINES PROVIDED WILL VOID WARRANTY AND DISCHARGE THE MANUFACTURER FROM ANY RESPONSIBILITY.

Unpacking

Unpack the carton and gently remove Lites Profile from the box. Ensure all parts and components of the Lites Profile received are undamaged.

In the event the Lites Profile shows any damage, do not use it and contact your transporter and seller immediately.

Items in the carton consist of:

- Lites Profile luminaire
- Colour frame
- Blue Neutrik PowerCon connector
- This owner's and service manual



Safety information for use and maintenance of the Lites Profile

- Lites Profile is for professional use only and NEVER for domestic use.
- Users must comply with manufacturer's guideline that follows; any other use in contrast with the provided information will void warranty and will free the manufacturer from any legal responsibility
- Never use Lites Profile on any flammable surfaces.
- Minimum distance from any flammable source: 0.25m.
- Minimum throw distance from illuminated surface: 1m.
- Installation of the unit(s) must be secured with adequate clamps, safety cords, nuts and bolts to bear twice the weight of the whole unit(s).
- Always power Lites Profile to safety circuit breakers. Lites Profile MUST NOT and CAN NOT be operated via Phase Control Dimmer.
- Install Lites Profile in a climate controlled room, which temperature must not exceed + 35°C (+ 95° F)
- Caution: when in operation some outer body parts of the Lites Profile can reach temperatures of up to + 60°C (+ 140° F).
- Lites Profile must be fitted with protection shields (Lenses).
- Always disconnect power, (always check twice that power is off) before Servicing/Operating the unit.
- Lites Profile is rated Class I.
- Protection rating IP20.
- Earth connection is MANDATORY!
- LED core must never be touched in any way as it may impair its use.
- An essential and periodic thorough cleaning of the Lites Profile is recommended, to clear dust or other impurities that may affect proper operation of the unit. Lenses must be cleaned to remove layers of dust that may impede and/or reduce the passage of light through lenses. Thorough and periodic cleaning is necessary to keep fans and vents clean – ensuring the best conditions and performance of the Lites Profile. Never touch the yellow LED core in any way, nor use solvents - as this can damage the LED beyond repair. Protection shields (lenses) - if worn out - must be replaced with new ones.



CE APPROVALS

The Lites Profile products to which this manual refers to, complies with European directive pursuant to:

2014/35/EU safety of electrical equipment supplied at low voltage (LVD)

2014/30/EU Electromagnetic compatibility (EMC)

2011/65/EU Restriction of the use of certain hazardous substances (RoHS)

WARRANTY

A 12-month warranty is granted on the Lites Profile from its purchase date. Warranty covers fabrication defects only - unit is not replaced but will be 100% fixed. Warranty is immediately voided if unqualified personnel have handled the Lites Profile. Any improper and/or unauthorised use, such as modification(s) or misapplication of the unit will also void the warranty. Removal of silver label showing technical data and serial number, or alteration of specs on said label, will immediately void warranty.

Technical specifications

Power Supply	100-240	V~ 50/60Hz
Maximum power consumption	170W (Bridgelux BXRC)	
Cos Ø	0,98	
Stand-by power consumption	5W	
Minimum ambient temperature	-10°C	
Maximum ambient temperature	35°C	
LED Colour Temperature:	2700°k, 3000°K, 4000°K,5600°K (to specify when ordering)	
LED CRI	90	
Colour frame dimensions:	160x160 mm	
Aluminium die-caste body to maximize heat dissipation		
LED Life	(see Manufacturers' specifications)	
Weight	7,5 Kg	
IP Rating	20	
Working position	As required	
Power connectors	IN & OUT Neutrik PowerCon	
Data connectors	IN & OUT XRL5	
Data protocols	DMX 512; RDM ready	
User interface	4-digit display and 4 buttons	
Manual operation:	Users must operate via buttons provided on the display	
Fan control:	Fan speed adjustment	
Control of LED frequency:	Selection of LED frequency refresh	
2 Dimming curves control:	Selection of two dimming curves control	
Accessories:	Iris diaphragm; Gobo holder (size B Ø 86 mm, image Ø 66mm)	

CE Compliant Dimensions (see picture)

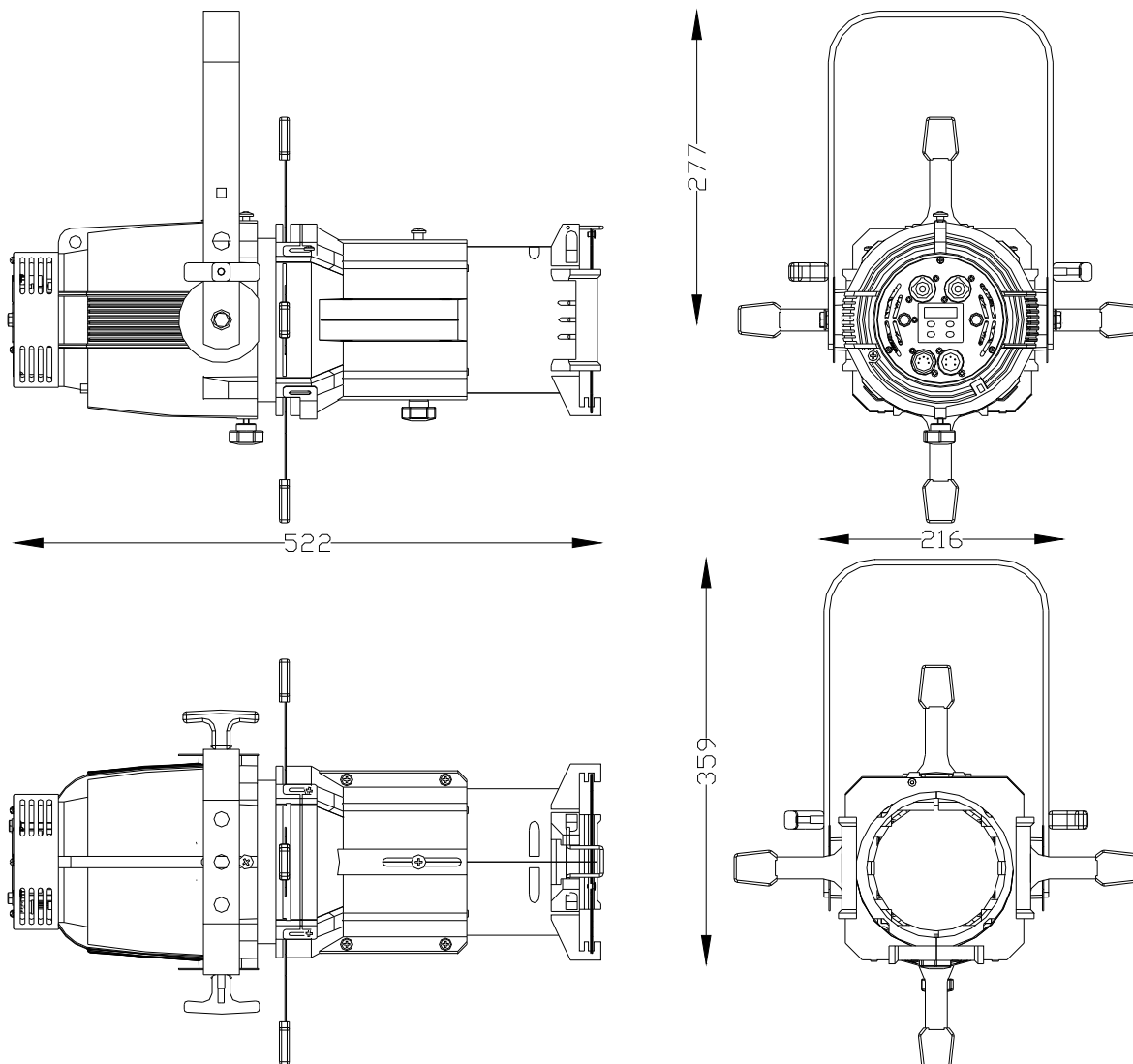

Lites Profile installation

Lites Profile is delivered with a robust yoke with 3 x 12mm mounting holes.

The use of an adequate C-clamp to sustain at least twice the weight of the Lites Profile (Lites Profile weighs 7,5 kg) and/or M10 screw is mandatory. The use of safety chain(s) to sustain twice the weight of the Lites Profile is also mandatory; the safety chain adds more protection to users and third parties. Eyelet for the safety chain is provided on the Lites Profile. The unit can be installed in any position (See Fig).

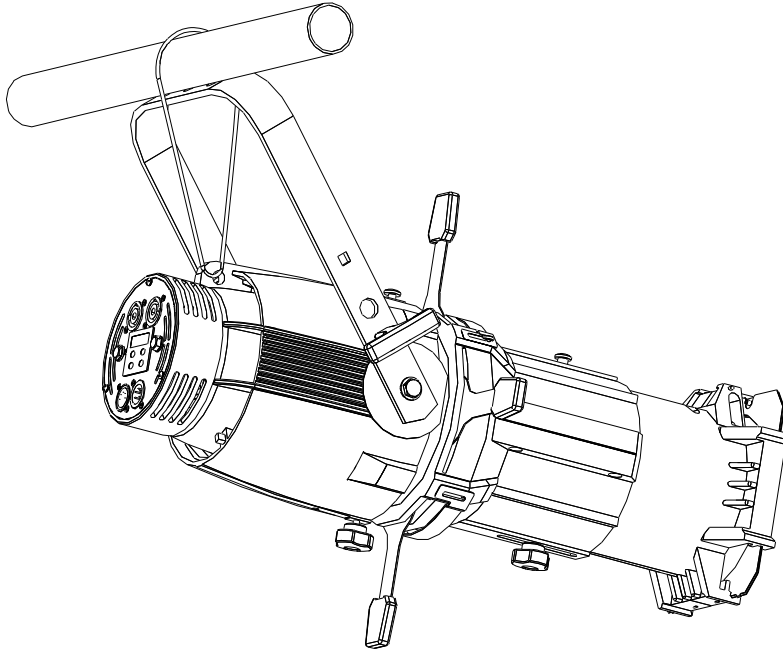

Connection to mains

WARNING! Installation(s) must be carried out by qualified personnel only and must comply with all norms in effect in the country of installation

Lites Profile is supplied with a free Blue Neutrik PowerCon plug that must be wired using a 3x1.5mm² lead which additional specifications include:

- Operating Voltage: 300/500V
- Test Voltage: 2KV
- Operating Temperature: -10°C / +35°C (- 14° F / +90° F)

Connect blue wire to N terminal, brown wire to L terminal, and Yellow/Green wire to earth terminal. Ensure connection to safety circuit breaker at all times. When connected to 230VAC, daisy chain must not exceed the quantity of 10 units, and not exceed 5 units when connected to 110VAC. Maximum daisy chain cable length: 20m.

WARNING: NEVER CONNECT LITES PROFILE ENGINE TO ANGLE PHASE DIMMER PACK OR TO NON-DIM MODE

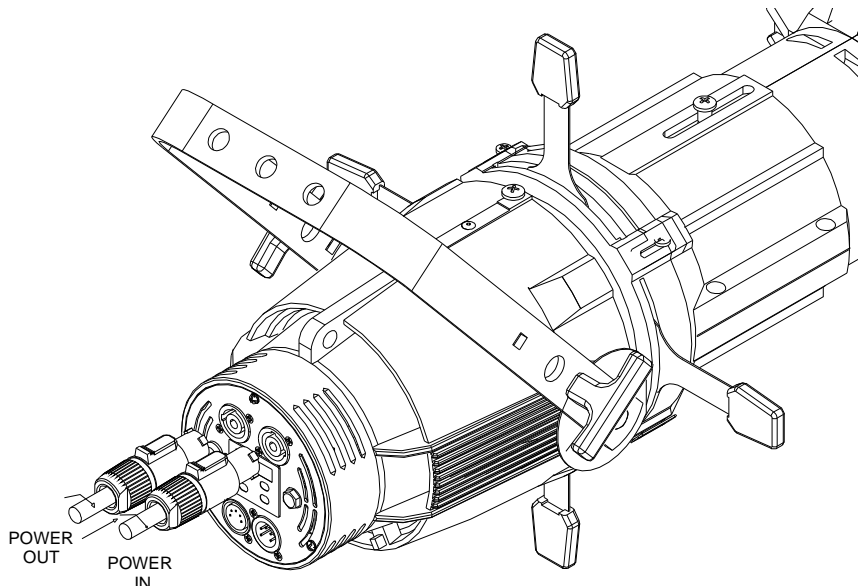

Signal control connection

Lites Profile can be operated via either DMX512A and/or RDM ready Protocols. For daisy chain DMX line, use a 2-lead wire plus shield.

Red LED dot is on when DMX Input is available. DMX off line when LED dot is off.

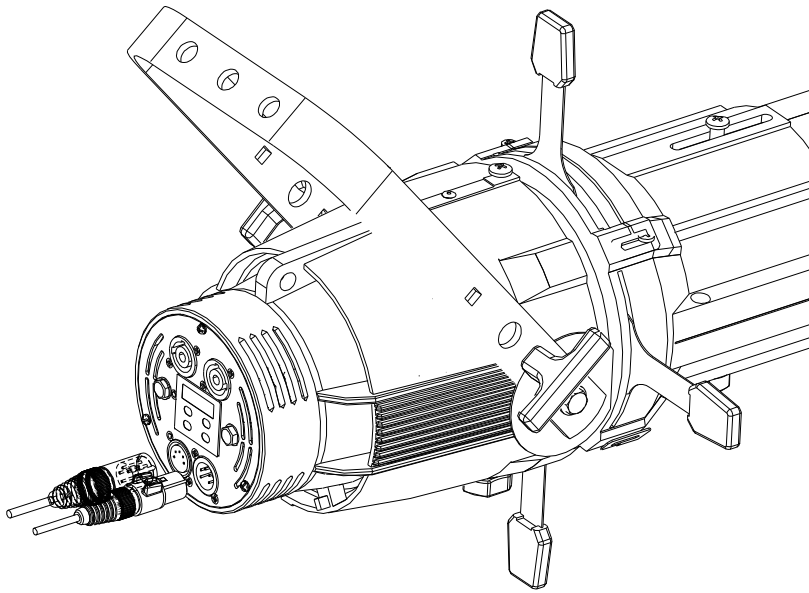

DMX XLR 5 Pin Assignment	
Pin	Description
1	GND
2	DMX-
3	DMX+
4	Not connected
5	Not connected

RDM – Remote Device Management

RDM Controller allows for remote standard operations.

RDM default options include:

Discovery mode: RDM is active when controller detects this mode; the device reports the Lites Profile by giving a flash of light (Controller sets the device to a listing to read: settings, DMX address, personality settings, i.e. DMX mode including all the above mentioned DMX values).

ON/OFF "Identify": This mode is to identify the manufacturer's device (Lites srl) - flash of light confirms selection.

Model information (HPLED-BUCK)

Software version information (HPLED-BUCK v.x.xx)

Mode to reveal temperatures of the LED and of the driver

Mode to reveal hour-meters of the LED and of the device

Focus

Loosen knob 5, then adjust optics to focus the projector.

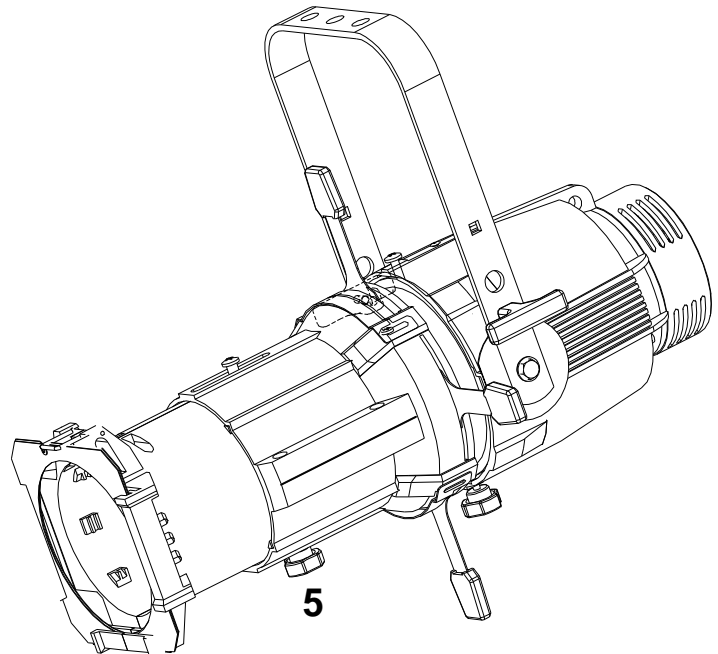

Shutter blade

There are 4 shutter blades, to shape patterns.

Installations of accessories

Gel frame

Lites Profile is delivered with a standard 160x160mm colour frame. The LED source used on Lites Profile allows the use of colour filters that cannot be used with high wattage tungsten lamps that would impair colour filters. Ensure that accessories installed on the Lites Profile are securely fitted in the gates and secured by the spring lock provided (see figure).

Gobo holder

Standard gobo holder (not included) can be used to house 'size B' gobos (Ø 86 mm, Ø 66 mm). Ensure gobo holder is securely fitted to the gate to avoid injury to third parties.

Iris diaphragm

Diameter of projected image may be changed with the use of an iris diaphragm (not included). To set Iris into its housing loosen the two M4 screws and move the bulkhead (see fig.). Ensure that iris is securely fitted into the gate to avoid injuries to third parties.

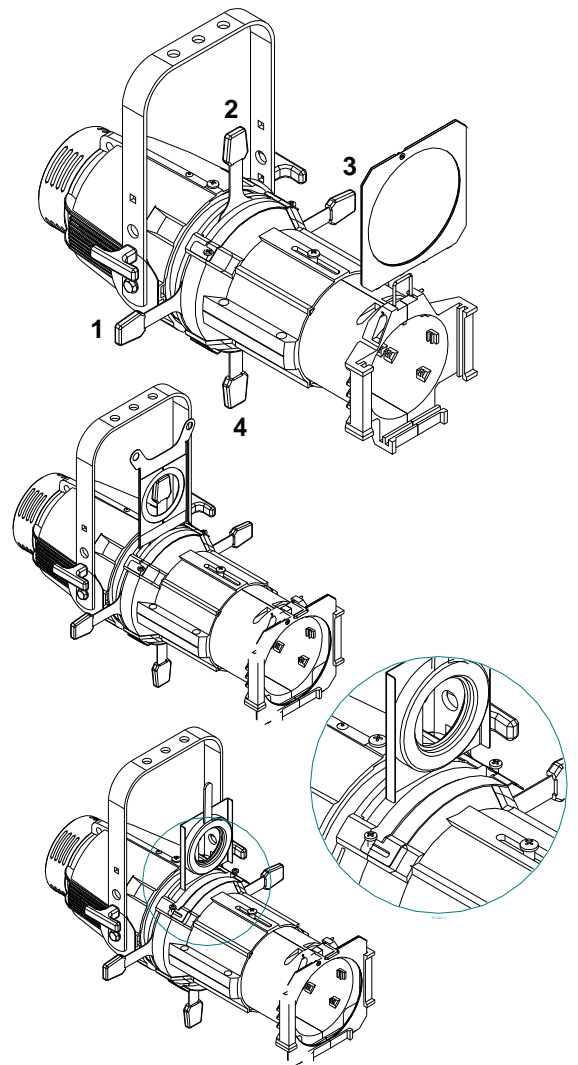

Power Lites Profile ON

WARNING! Before powering on Lites Profile, ensure that all installation procedures have been properly executed.

When Lites Profile is powered on, the setup display will show the software release version. The UP, DOWN, ENTER and ESC buttons allow the operations of Lites Profile menu. UP and DOWN buttons allow one to browse through menu options, the ENTER button is to confirm selection. The ESC button is to return to the previous menu or to quit previous setting(s).

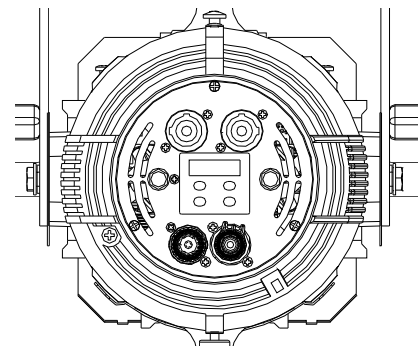

Menu items

Displayed Message	Allowed or displayed values	Function
Addr	001..510	Set Up DMX Address
Mode	1 ch 2 ch 3ch 4ch 5ch	DMX Operating mode (see next page)
Man	0..255	Manual light output adjustment (this is possible even if no DMX is present). Adjusted value will be stored on the internal permanent memory
drUt	..°C	Shows driver operating temperature
LEdt	..°C	Show led operating temperature
PUM	0..100%	Shows current led power (0-100%)
SMOO	FAST MED SLOW	DMX data speed adjustment

GAMM	Line qUAd	Dimmer profile selection: - Line for linear dimming regulation - qUAd for tungsten lamp emulation
booS	Off on	Boost selection: off = maximum led power at 90% on = maximum led power at 100%
PoS	AA VV	Display orientation selection: AA = normal VV = inverted
StbY	Off on	Standby display activity: off = display always switched on on = display switched off after few seconds of buttons inactivity (only the right side dot will be lighted to indicate DMX availability)
dEF	Off on	ON Will restore the default factory values
TiML	..h ..	Shows LED life
TiMU	..h ..	Shows HPLED life
SoFt		Shows Software version

DMX Operating Modes (Mode)

Lites Profile provides different DMX operating modes ensuring the ideal use of the DMX universe
Shutter/strobo, 8/16 bit dimmer, fan speed and LED frequency are adjustable.

1ch mode

Channel	Function	DMX Values	
1	Dimmer	0..255	Light output: 0=Off, 255=Maximum Power

2ch mode

Channel	Function	DMX Values	
1	Shutter	0-9	off
		10..255	Strobe effect from slow to fast
2	dimmer	0..255	Light output: 0=Off, 255=Maximum Power

3ch mode

Channel	Function	DMX Values	
1	shutter	0-9	off
		10..255	Strobe effect from slow to fast speed
2	dimmer	0..255	Light output: 0=Off, 255=Maximum Power
3	Fan speed	0..24	Fan at slowest speed
		24..255	Fan speed from slow to fast

4ch mode

Channel	Function	DMX Values	
1	shutter	0..9	off
		10..255	Strobe effect from slow to fast speed
2	dimmer	0..255	Light output: 0=Off, 255=Maximum Power
3	Fan speed	0..24	Fan at slowest speed
		24..255	Fan speed from slow to fast
4	Frequency Modulation	0..24	PWM Frequency 1KHz
		25..49	PWM Frequency 2KHz
		50..74	PWM Frequency 3KHz
		75..99	PWM Frequency 4KHz
		100..124	PWM Frequency 5KHz
		125..149	PWM Frequency 6KHz
		150..174	PWM Frequency 7KHz
		175..199	PWM Frequency 8KHz
		200..224	PWM Frequency 9KHz
225..255	PWM Frequency 10KHz		

5ch mode

Channel	Function	DMX Values	
1	shutter	0..9	off
		10..255	Strobe effect from slow to fast speed
2	Dimmer Coarse	0..255	Light output: 0=Off, 255=Maximum Power – Coarse
3	Dimmer Fine	0..255	Light output: 0=Off, 255=Maximum Power - Fine
4	Fan speed	0..24	Fan at slowest speed
		24..255	Fan speed from slow to fast
5	Frequency Modulation	0..24	PWM Frequency 1KHz
		25..49	PWM Frequency 2KHz
		50..74	PWM Frequency 3KHz
		75..99	PWM Frequency 4KHz
		100..124	PWM Frequency 5KHz
		125..149	PWM Frequency 6KHz
		150..174	PWM Frequency 7KHz
		175..199	PWM Frequency 8KHz
		200..224	PWM Frequency 9KHz
225..255	PWM Frequency 10KHz		

Error messages

In case of malfunction, the following messages may appear:

- HP Fan Error: means problems on 80x80x10 fan
- Temperature Error: LED sensor might be defective and/or unit has over-heated

Should either of the above messages appear, the LED will automatically switch off. Refrain from further use of the Lites Profile and promptly contact any authorized service centre.

Periodic maintenance

To ensure proper Lites Profile operation, we suggest the following periodic maintenance operations:

- Remove dust or any kind of other dirt from the fans and loop-holes, to ensure correct air flow
- Remove dust from lenses using a clean cloth, to ensure maximum light efficiency
- Replace damaged protection screen and lenses when necessary

Do not touch nor clean the LED nor the yellow area around it with any solvent whatsoever

Device disposal information

At the end of its life, Lites Profile must be disposed of at an appropriate electrical/electronic equipment waste collection centre. Eco-friendly disposal helps avoid possible negative impact on the environment and human health, and promotes the re-use and/or recycling of materials making up the product. Illegal disposal may result in administrative sanctions as provided by applicable laws.



Manufacturer declines any sort of personal/corporate responsibility/liability for damages caused by the inadequate/incorrect use of the product, as well as if the product has been handled by unqualified personnel. Non-compliance with security norms and/or periodic maintenance as expressed in this manual release manufacturer from all personal/corporate responsibility/liability.

Text, wording, drawings, specifications, modifications and other changes to this manual may be applied at any time without notice. The specifications are not binding.

Lites Profile White 03/01/2018 rev.01