

HPLED C5

Colour RGBWA

Lites s.r.l.
Simply LED to innovation

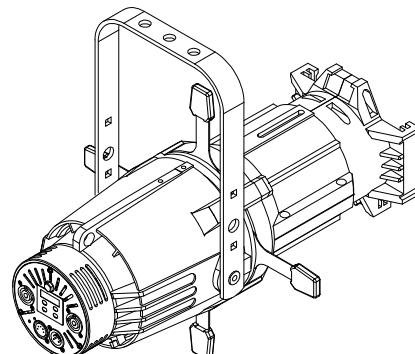
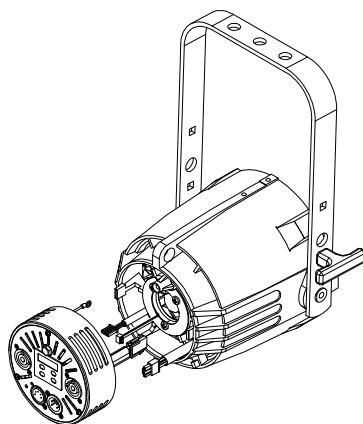
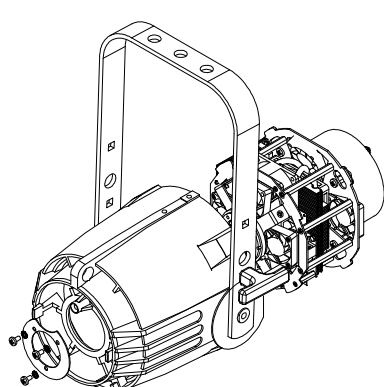
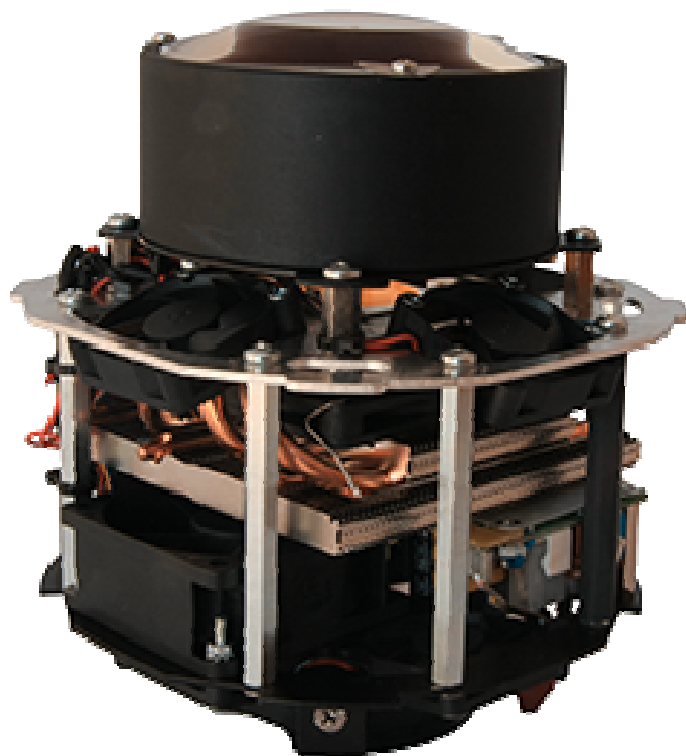

HPLED C5

The HPLED C5 is the sibling re-lamping engine of the HPLED “white series” but it is powered by a 5 line-up of high-power coloured LEDs. Each array comprises, respectively, **Red, Green, Blue, White and Amber LEDs** offering an unlimited colour palette. The HPLED C5 engine marks a new stage in the traditional colour changers’ division because it replaces traditional tungsten bulbs and secures unwanted shades providing seamless and colour consistency distribution stances across the illuminated areas. The convenient DMX and/or RDM ready protocols do away with obsolete and cumbersome dimmer-packs reviving existing profile-luminaires. The Integrated display board facilitates fixture set-up and protection sensors ensure LED safety operations; the silent cooling fan with speed adjustment makes this engine the exemplary profile luminaire for any installation. The HPLED C5 also sports 16-bit resolution, 5 Pin IN/OUT and power-con connectors and it is a totally free-flicker engine. Remarkably HPLED C5 draws only 170W, a valuable and rewarding asset to save on power bills. Product of Italy. (Designed and manufactured by Lites srl).

HPLED C5

Colour RGBWA

Lites s.r.l.
Simply LED to innovation

Technical specifications

Power Supply: 100–240V ~ 50/60Hz auto-setting (single-phase)

Maximum power consumption: 170W

Stand-by power consumption: 5W

cos Ø 0,98

Minimum room temperature: -10°C

Maximum room temperature: 35°C

Available led colour : 5-colour RGBWA LED array (red, green, blue, white 5000°k, amber)

Minimum CRI : 90

Double lens optics with multiple anti-reflection coatings

LED life 50.000 Hrs (see manufacturer's specifications)

Protection grade: IP20 (HOUSE HPLED in original ETC S4 only)

Working position: any

Datum Protocols: DMX 512, and-or RDM ready

Power connectors: IN – OUT neutrik power-con connectors

Data connectors: IN – OUT neutrik XRL 5

User interface: 4 digit display and 4 keys

Manual operation: operations via keys provided on the display

Control of led frequency: selection of led frequency refresh

Fan control: fan speed adjustments

Dimming curves control: selection of two dimming curves control

Net weight: 2,03 kg

Packed weight: 3 kg

Pack volume 0,012 m³

Compliant to :



Photometric data (all channels set to 100%)

Measurements carried out using LEDs arrays for a period of 30 minutes at 25°C room temperature and with the use of a 25° ETC 's optics. . Data are informatory and not binding

Source 4 optics 19°	Lux	1688	750	422	270	188	138
	Diameter ø m	1,20	1,8	2,40	3,0	3,6	4,2
	Distance m	4 m	6 m	8 m	10 m	12 m	14 m
Source 4 optics 26°	Lux	1094	486	273	175	122	89
	Diameter ø m	1,65	2,48	3,31	4,41	4,97	5,79
	Distance m	4 m	6 m	8 m	10 m	12 m	14 m
Source 4 optics 36°	Lux	788	350	197	126	88	64
	Diameter ø m	2,32	3,48	4,64	5,81	6,97	8,13
	Distance m	4 m	6 m	8 m	10 m	12 m	14 m
Source 4 optics 50°	Lux	375	167	94	60	42	31
	Diameter ø m	3,73	5,59	7,46	9,32	11,19	13,05
	Distance m	4 m	6 m	8 m	10 m	12 m	14 m

Dimensions:

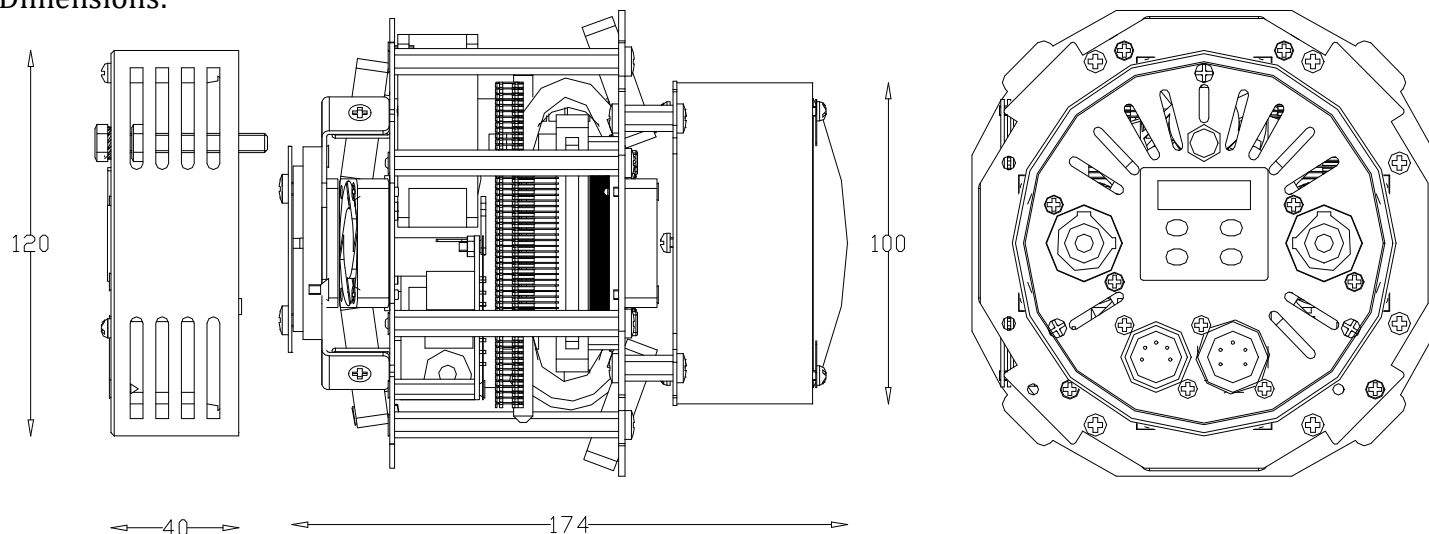

Data provided are informatory only and not binding. Values data and other information may be changed without notice.